



Iso-Flate

High performance
seal solutions



Inflatable seals for the Marine Industry



Inflatable Seals

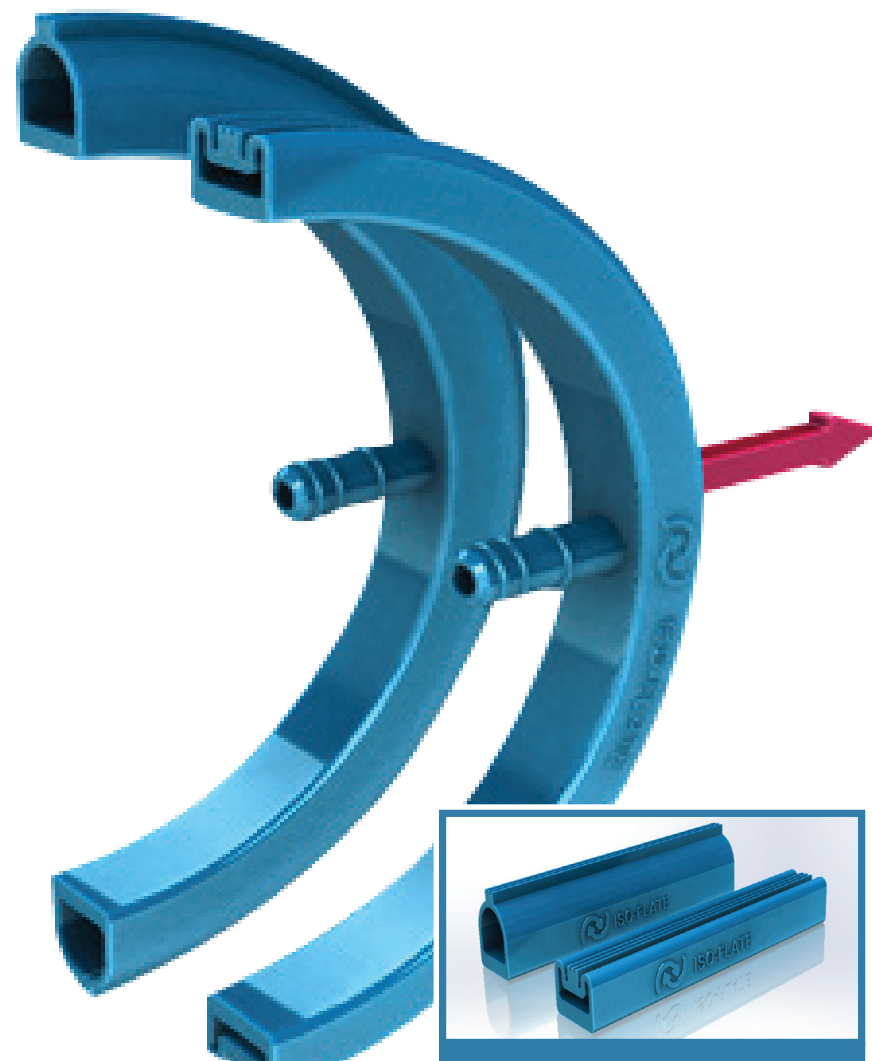

Inflatable seals



Machined seal housings



“Contact us to talk to our sales engineers or to arrange a site visit to discuss your application or requirement in detail.”



Inflatable seals



Containment doors

The ISO-FLATE(TM) range of inflatable seals are an ideal solution for reliable weather tight and UV/ saltwater resistant sealing. Our team has all the experience, and latest 3D modeling technology available to work with you from the outset, and develop a high end solution using existing or bespoke profiles.

Guarantees / Accreditations

- ✓ ISO 9001 accreditation
- ✓ Individual seal pressure test certification

Product Features

- Precision Spark Eroded Vulcanisation tooling, and strict extrusion tolerance ensures highest quality of vulcanisation
- Over 100 profiles available in FDA silicone, Anti-Microbial Silicone, FDA EPDM, FKM and many other materials
- Precision moulded rubber valves, and machined steel valves to suit vast range of housings adhering to stringent leak rates
- Unique seal identification number providing detailed traceability for each individual seal supplied
- Rapid cycle fatigue testing available providing accurate, application specific cycle life estimates
- High Quality of Vulcanisation in almost any RAL number for aesthetically stunning seal/door combinations



Inflatable seals

We can produce an incredible number of different designs , using our wide range of profiles and tooling (including 90 degree corner seals for axial inflation). Below is just a short selection of marine applications we have covered...

Typical Marine Uses

- Transom Hatches
- Patio Doors
- Companion way doors
- Tender Doors
- Sun Decks
- Forward Hatch Seals for racing
- Composite moulding
- Vacuum forming



Bespoke door and window seals



Inflatable Seal Profiles

Below is a small selection of available Iso-Flate™ profiles. Here at Sealing Projex we actively encourage technical interaction between our team and your engineers in order to choose the correct profile, however should you require more detailed information on one of the below profiles specifically, please feel free to request a data sheet.

Profiles

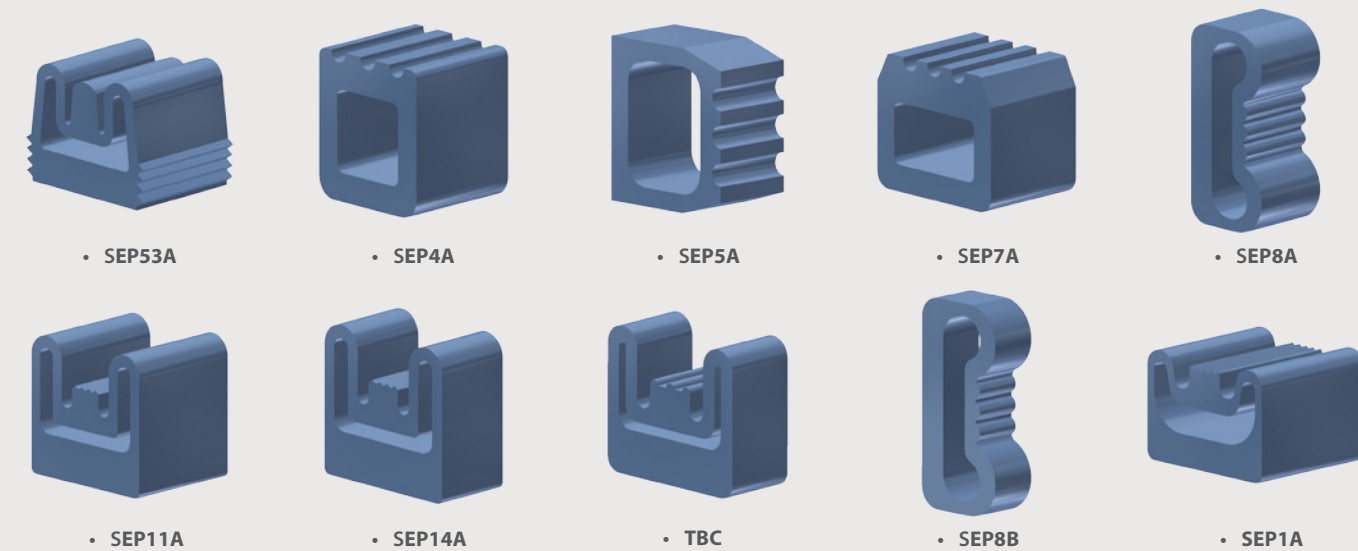

Specifications

| Profile Reference | Width (mm) | Relaxed Height (mm) | Inflated Movement (mm) |
|-------------------|------------|---------------------|------------------------|
| SEP53A | 17 | 14 | 8 |
| SEP4A | 16 | 18 | 3 |
| SEP5A | 35 | 32 | 6 |
| SEP7A | 20 | 17.5 | 4 |
| SEP8A | 50 | 24 | 18 |
| SEP11A | 24 | 23 | 12 |
| SEP14A | 35 | 28 | 20 |
| TBC | TBC | TBC | 9 |
| SEP8B | TBC | TBC | 28 |
| SEP1A | 17 | 12 | 6 |



*All of the above information is given as a guideline only, for more detailed technical guidance please contact the iso-flate™ technical team.



Profiles

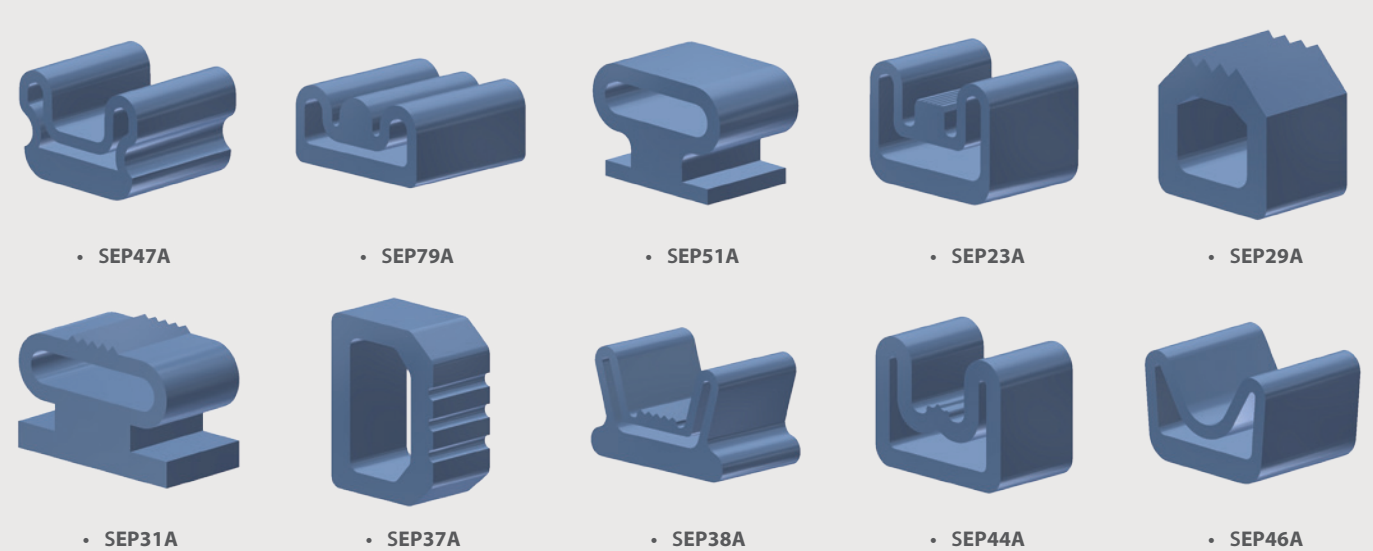

Specifications

| Profile Reference | Width (mm) | Relaxed Height (mm) | Inflated Movement (mm) |
|-------------------|------------|---------------------|------------------------|
| SEP47A | 18 | 12 | 9 |
| SEP48A | 17 | 8 | 7 |
| SEP51A | 25 | 19 | 10 |
| SEP23A | 20 | 15 | 12 |
| SEP29A | 20 | 20 | 4 |
| SEP31A | 30 | 21 | 13 |
| SEP37A | 34 | 27 | 5 |
| SEP38A | 24 | 16 | 11 |
| SEP44A | 26 | 20 | 13 |
| SEP46A | 20 | 13 | 7 |



Portable rapid cycle testing at Sealing Projex or at the clients premises

*All of the above information is given as a guideline only, for more detailed technical guidance please contact the iso-flate™ technical team.

35 years of experience in designing and producing
seals for the most demanding applications

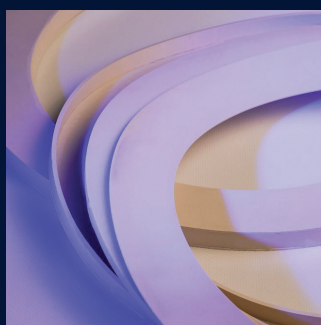

More Information

Tel: +44 (0)1942 604107
or visit www.sealingprojex.com

Sealing Projex
C2,-C7 Premier Centre
Abbey Industrial Estate
Romsey, Hampshire
SO51 9DG United Kingdom

